

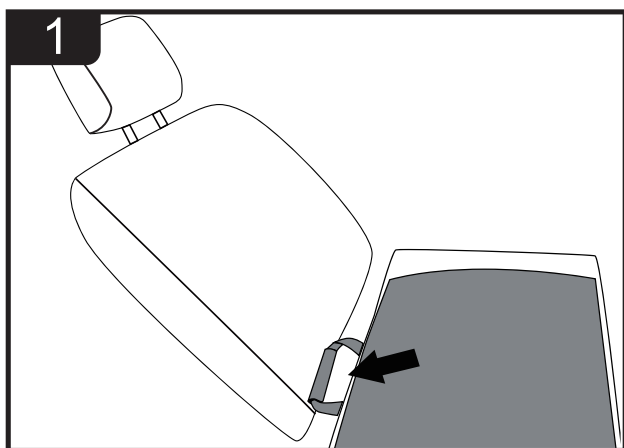

MODEL PT4004-1 / PT4005-1 / PT4005-2 / PT4008-1

INSTALLATION INSTRUCTION



Step 1 - Tuck the seat anchor in between the back and seat cushions.

- ① Seat Anchors
- ② Headrest Straps
- ③ The Backing Strap

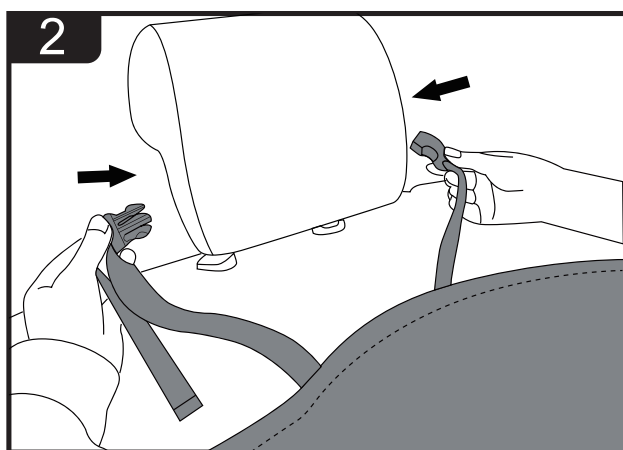
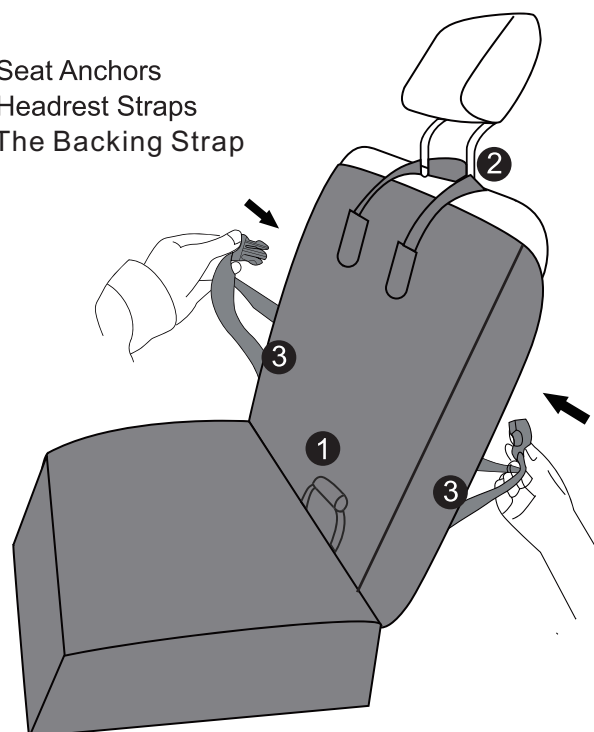

Step 2 - Snap the buckle straps to the backing of the seat and the headrest, adjust to the suitable length.

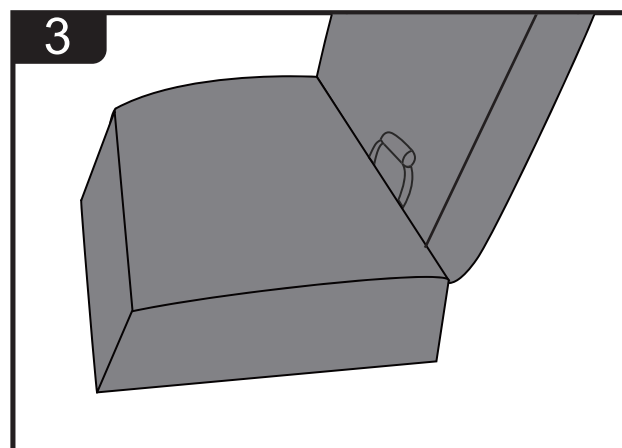

Step 3 - Make sure the bottom is placed correctly and seatbelt buckle can be easy to access.